



MakeUp  
Skin  
Keyboard

ISTRUZIONI DI MONTAGGIO  
*ASSEMBLY INSTRUCTIONS*  
INSTRUCTIONS DE MONTAGE  
*MONTAGEANLEITUNG*  
INSTRUCCIONES PARA EL MONTAJE  
*ИНСТРУКЦИИ ПО МОНТАЖУ*  
安装说明

Rev. 1.1\_02/2026

**Low Voltage Architectural Control Interface  
(Decorative wall-mounted control device for Class 2 systems)**

This product is designed for Class 2 low-voltage systems (<24V DC); is assembled using UL Recognized components (switches, LEDs, plastics where applicable); complies with European directives (CE marking, where applicable)  
Important Notice: This product is not UL Listed as a complete assembly.

Indice - Index - Index - Inhaltsverzeichnis - Índice - Содержание - 索引

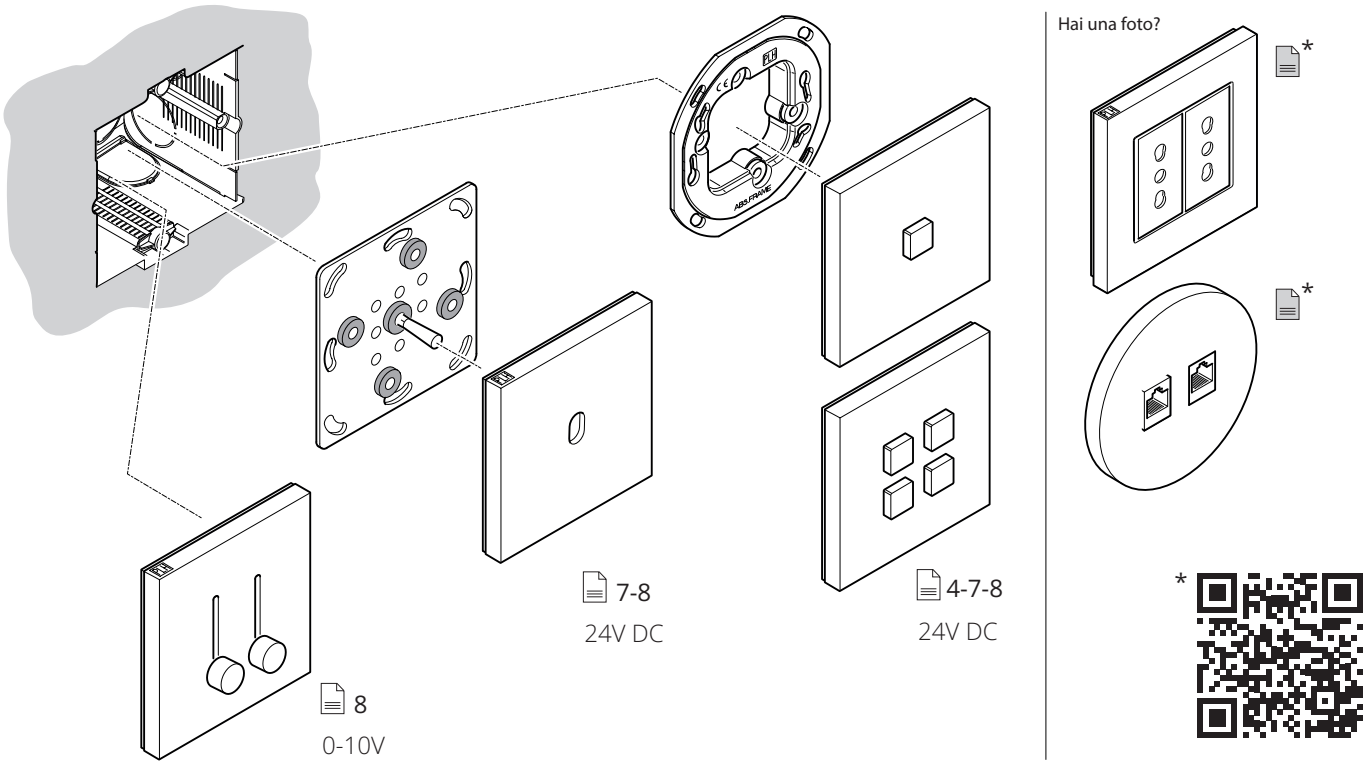

Standard 502

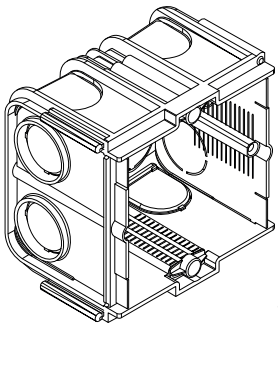

.. e multipli  
.. and multiple  
.. et multiples  
.. und Mehrfachausführungen  
.. y múltiples  
.. и многоместные  
.. 及多联

Standard Swiss

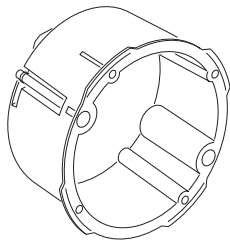

.. e multipli  
.. and multiple  
.. et multiples  
.. und Mehrfachausführungen  
.. y múltiples  
.. и многоместные  
.. 及多联

Standard British

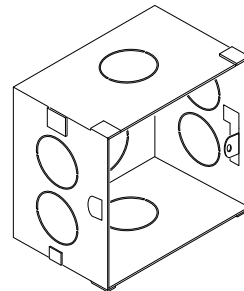

.. e multipli  
.. and multiple  
.. et multiples  
.. und Mehrfachausführungen  
.. y múltiples  
.. и многоместные  
.. 及多联

Legenda - Legend - Légende - Legende - Leyenda - Условные обозначения - 图例

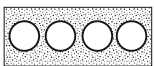

1 Layer

Cartongesso / Gypsum board  
Plaque de plâtre / Gipskarton  
Panel de yeso / Гипсокартон  
石膏板



Muro / Wall  
Mur / Ziegelwand  
Muro / Кирпич  
墙壁



Marmo / Marble  
Marbre / Marmor  
Mármol / Мрамор  
大理石



Legno - mdf / Wood - mdf  
Bois - mdf / Holz - MDF  
Madera - mdf / Дерево - МДФ  
木材 - MDF

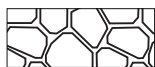

Pietra / Stone  
Pierre / Steinmauer  
Piedra / Камень  
石材



Cemento armato / Vibrated concrete\*  
Béton armé / Stahlbeton\*  
Cemento armado / Железобетон\*  
钢筋混凝土

\*Montaggio da definire con l'ufficio tecnico / Assembly to be defined with technical office / Montage à définir avec le bureau technique  
\*Montage mit dem Technischen Büro abzustimmen / Montaje que definirse con la oficina técnica / Монтаж согласовывается с техническим отделом / 需与技术部确认安装

Kit - Kit - Kit - Bausatz - Kit - Комплект - 套件

- |                            |                             |                  |
|----------------------------|-----------------------------|------------------|
| 1. Layer con componenti    | 2. Layer con adattatori     | 3. Accessori     |
| 1. Layer with components   | 2. Layer with adapters      | 3. Accessories   |
| 1. Gabarit avec composants | 2. Gabarit avec adaptateurs | 3. Accessoires   |
| 1. Lage mit Bauteilen      | 2. Lage mit Adaptern        | 3. Zubehör       |
| 1. Estrado con componentes | 2. Estrado con adaptadores  | 3. Accesorios    |
| 1. Слой с компонентами     | 2. Слой с адаптерами        | 3. Комплектующие |
| 1. 含组件的分层                  | 2. 含适配器的分层                  | 3. 配件            |

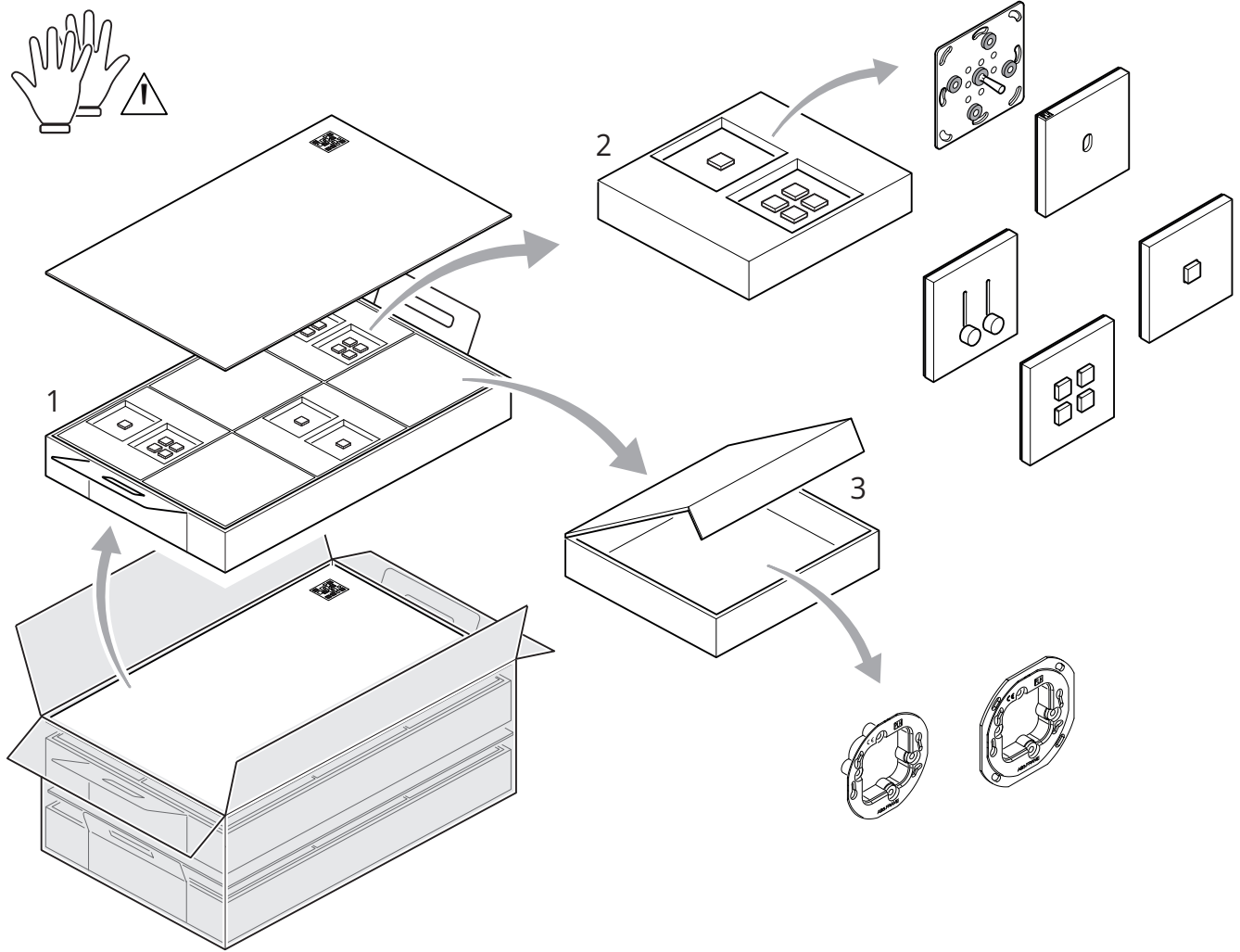

Utensili - Tools - Outils - Werkzeuge - Utensilios - Инструменты - 刀貝

Non forniti da PLH® / Not provided by PLH® / Non fournis par PLH® / Nicht von PLH® geliefert / No suministrados por PLH® / Не поставляются компанией PLH® / 非PLH®提供

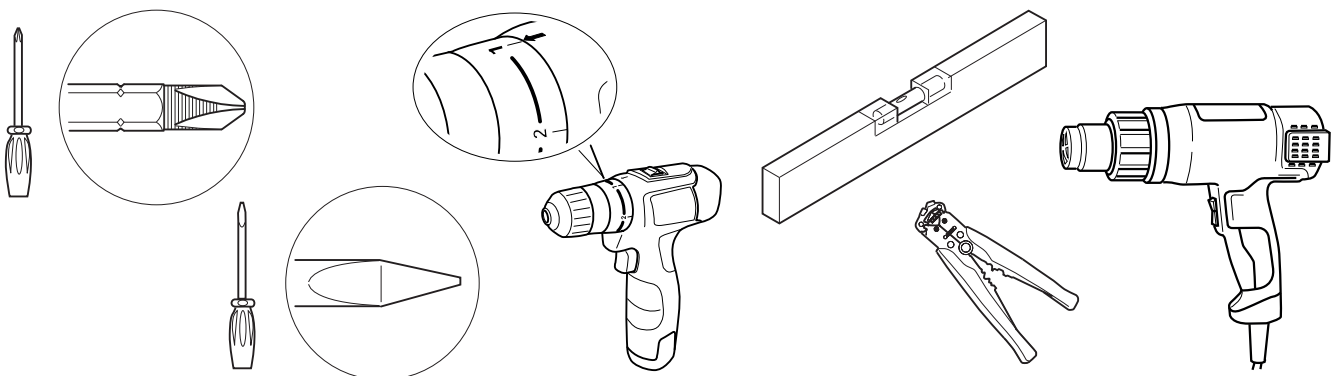

Posizione scatola elettrica - *Wall box position* - Position de la boîte électrique - *Position der Elektroanschlussdose* - Posición de la caja eléctrica - *Расположение электрической коробки* - 电气箱位置

Per il montaggio della scatola elettrica fare riferimento alle istruzioni del produttore. / Refer to the manufacturer's instructions for mounting the wall box.  
 Pour l'installation de la boîte électrique, se référer aux instructions du fabricant. / Für die Montage der Elektroanschlussdose beachten Sie die Anweisungen des Herstellers.  
 Para la instalación de la caja eléctrica, consulte las instrucciones del fabricante. / Для установки электрической коробки следуйте инструкциям производителя.  
 安装电气箱时，请参照制造商的说明。

1

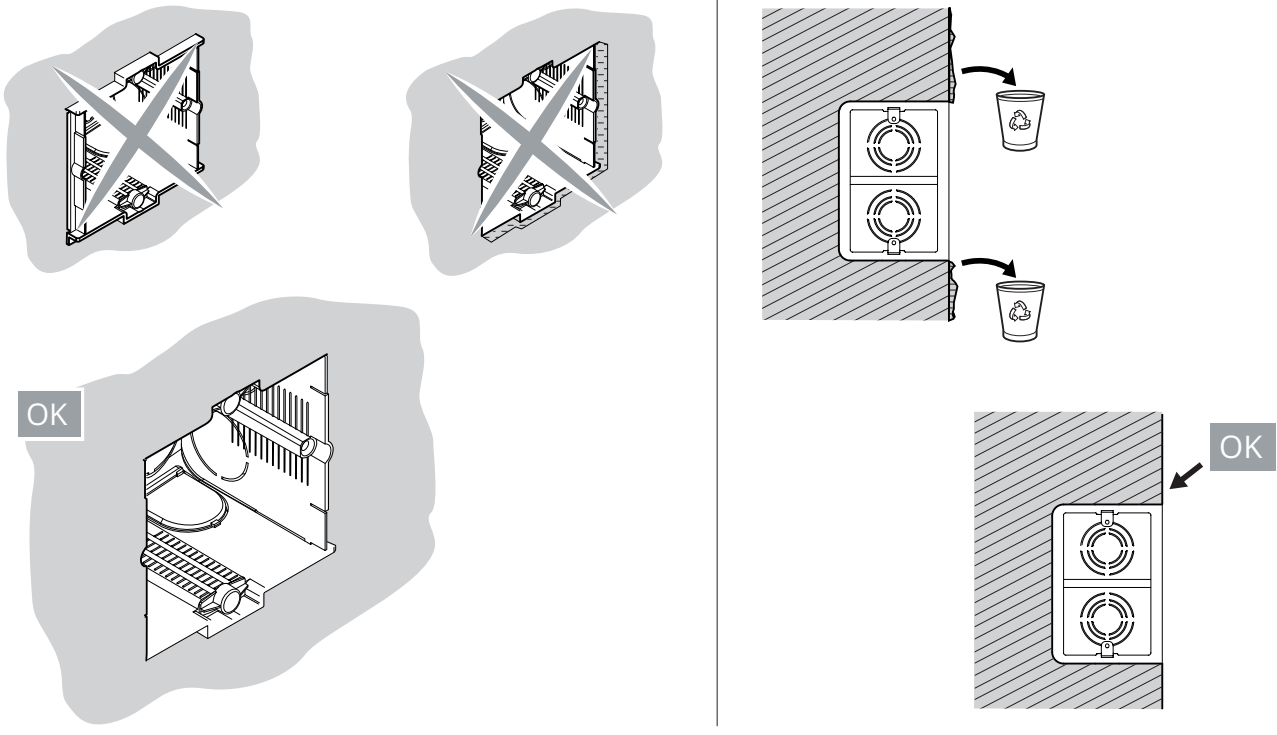

2

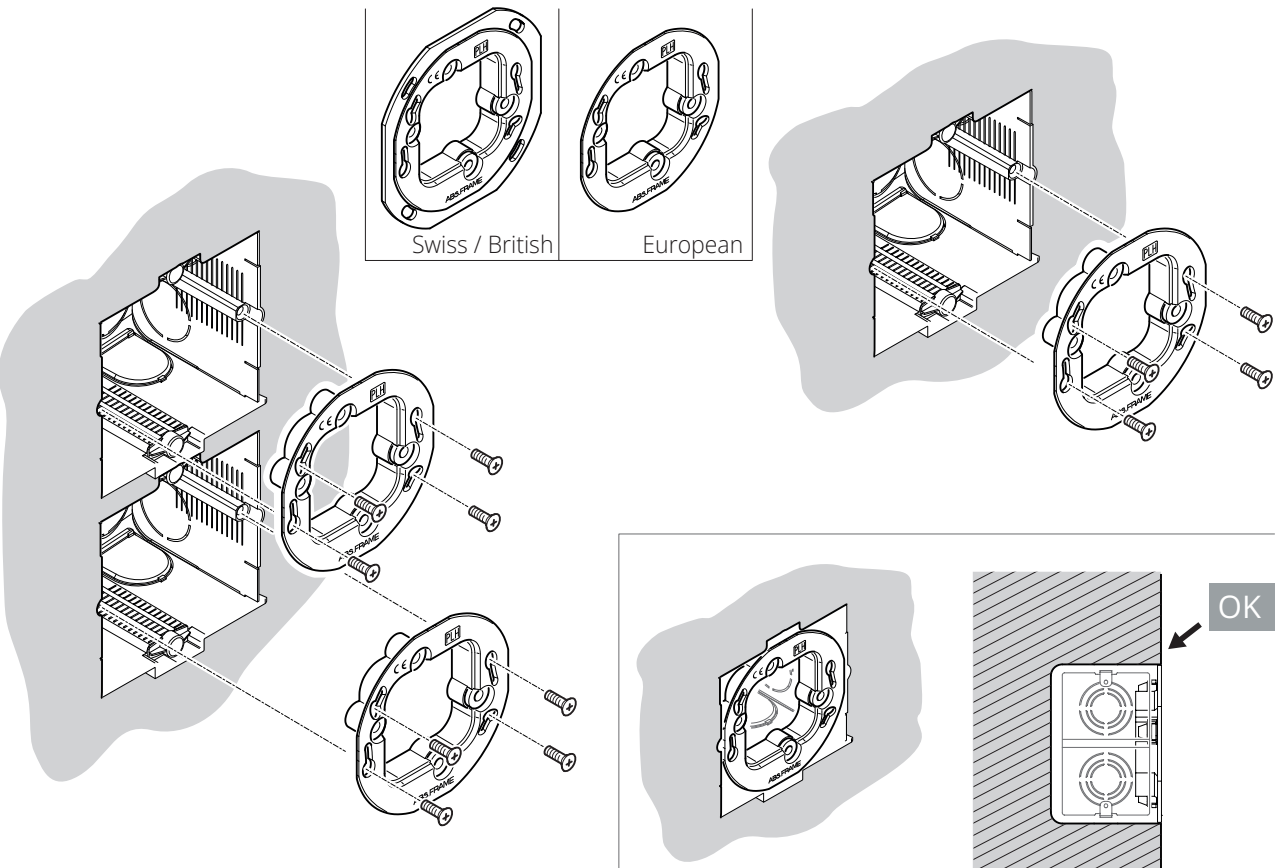

# Collegamento - Connection - Branchement - Anschlüsse - Conexión - Подключение - 连接

Operare sempre in sicurezza / Always operate safely / Travailler toujours en toute sécurité / Stets sicher arbeiten / Trabaje siempre con seguridad / Всегда работайте безопасно / 始终安全操作

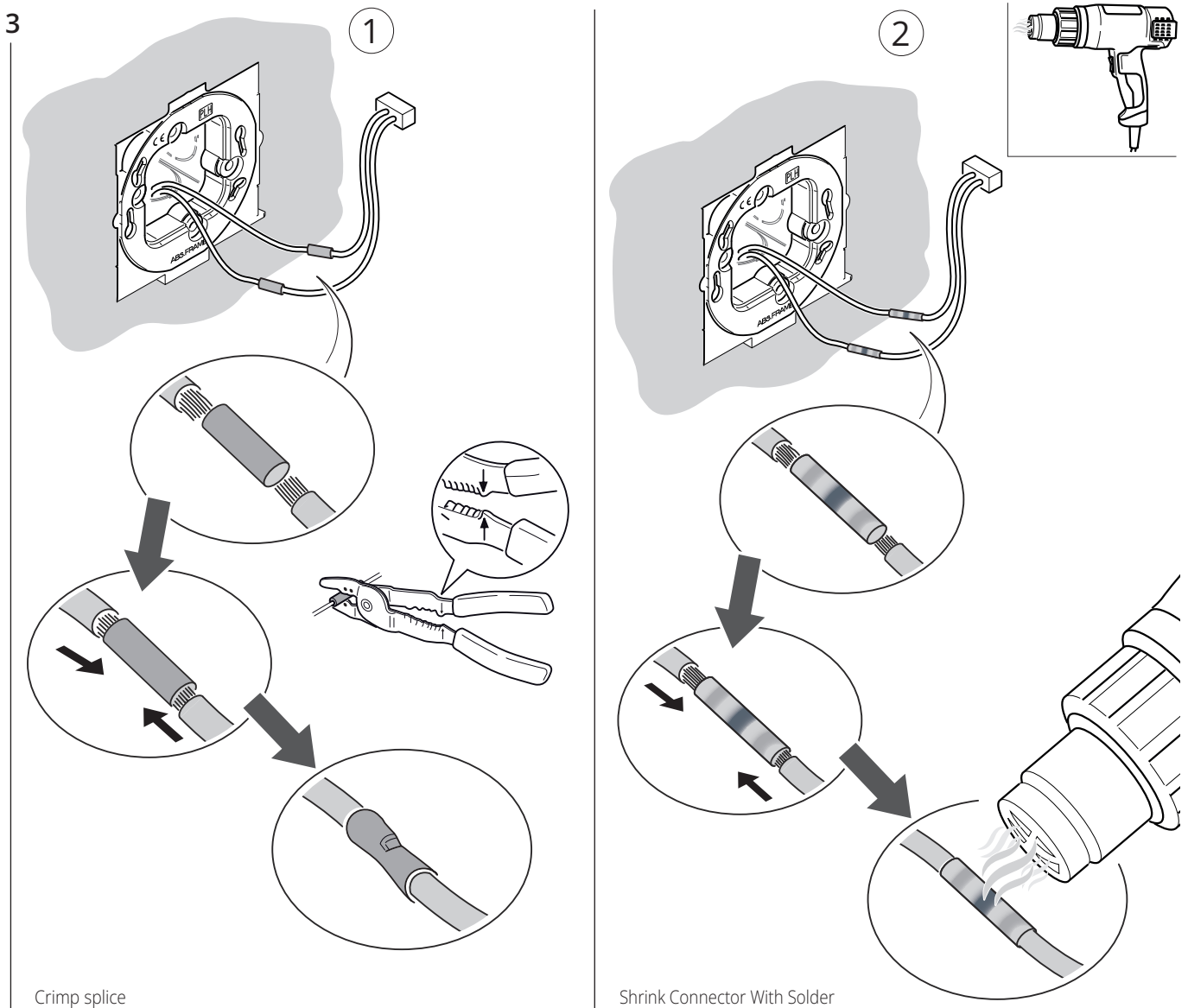
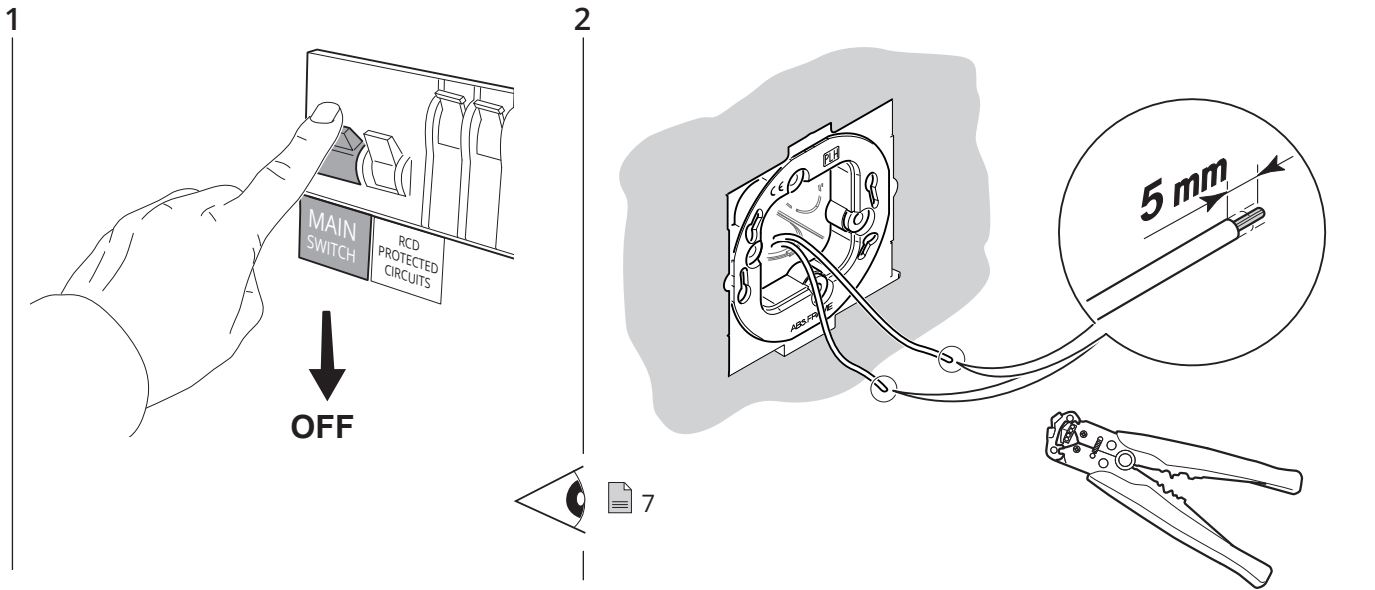

! MAX. 30V

1

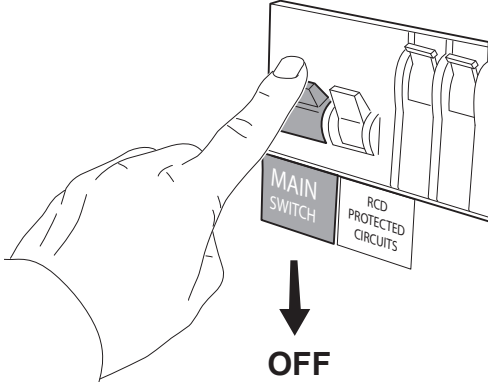

2

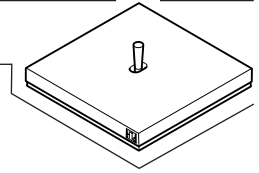
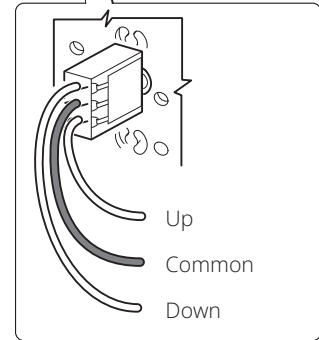
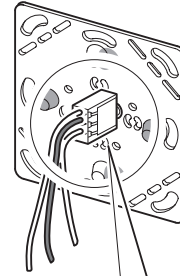
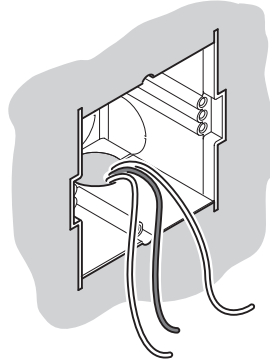

OLD TYPE

! MAX. 30V

Double push

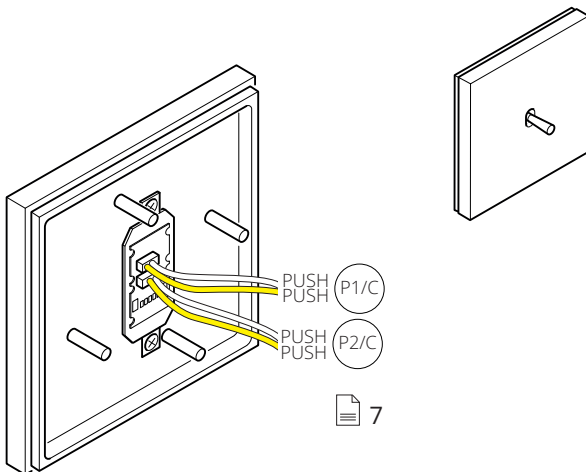

Double push WITH LED

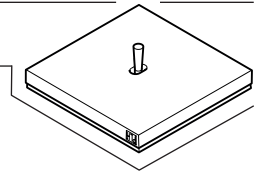
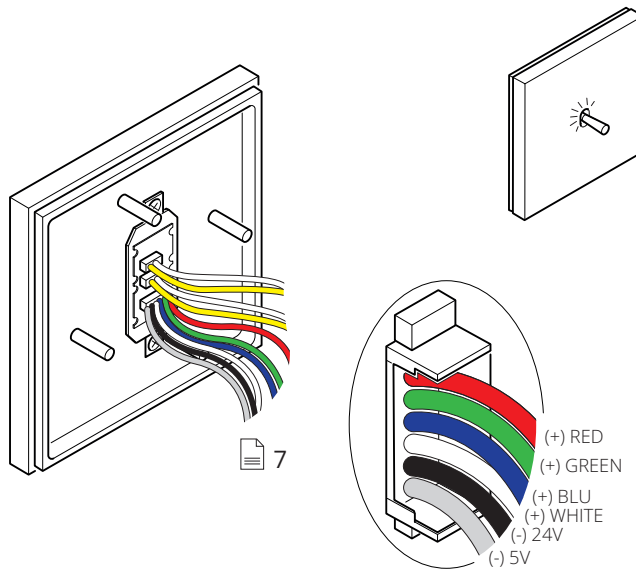

NEW TYPE

MAX. 24V

Push

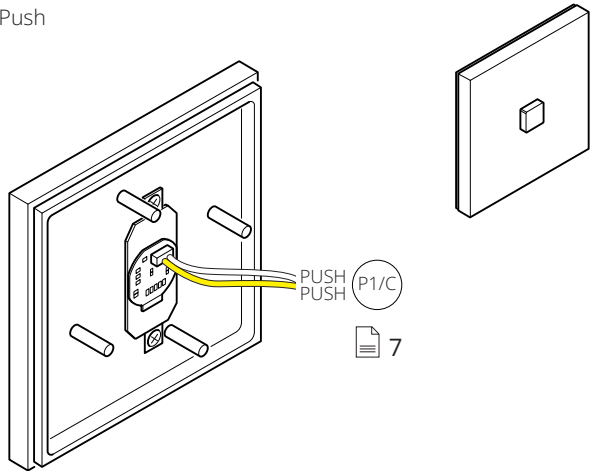

Push WITH LED

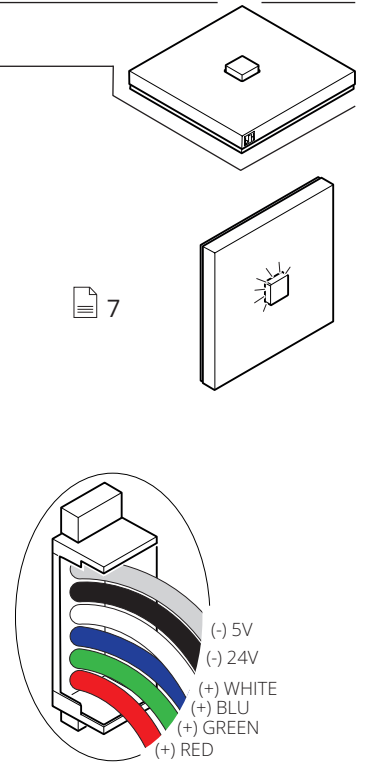
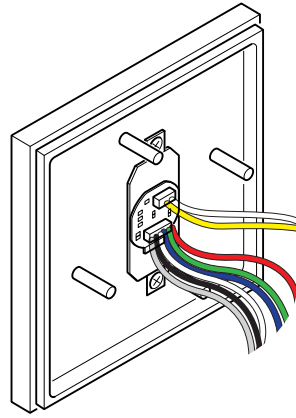

100 KΩ \*

\*10 KΩ su richiesta / 10 KΩ on request / 10 KΩ sur demande / 10 KΩ auf Anfrage / 10 KΩ bajo pedido / 10 KΩ по запросу / 10 KΩ 可按要求提供

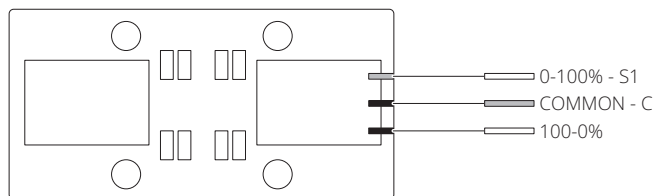
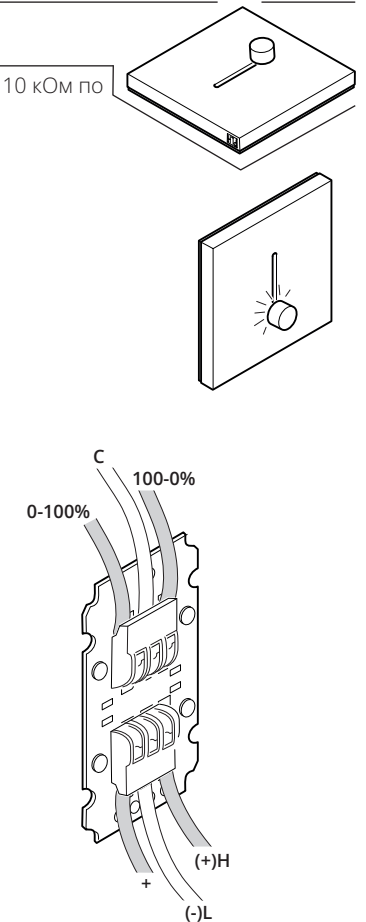
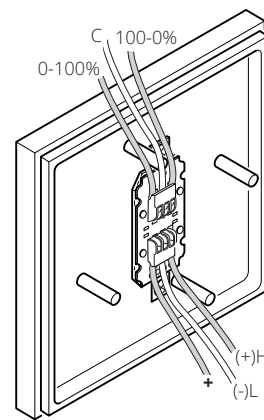
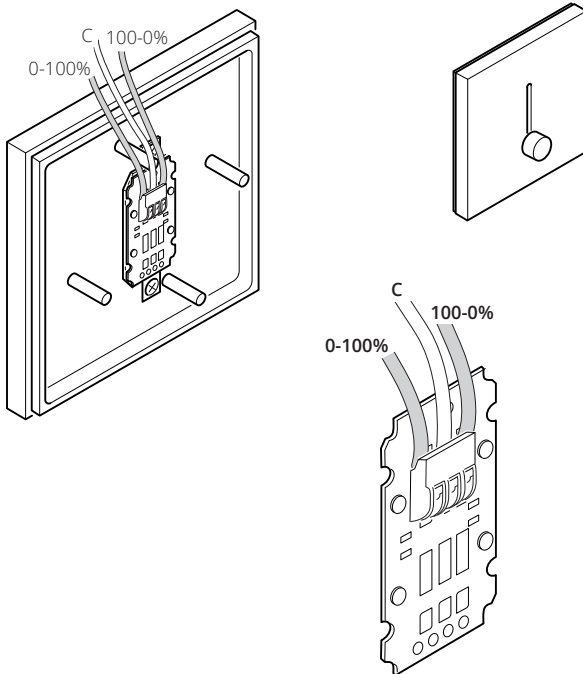

LED MAX. 24V

CONNECTION WITH PLH A.SP (Casambi)

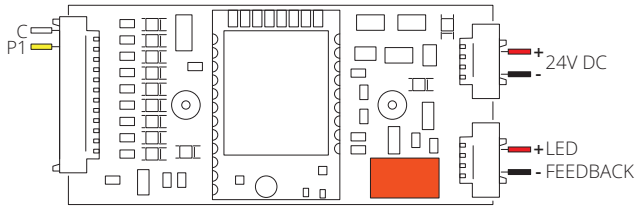

CONNECTION WITH CRESTRON C2N-UNI8IO  
Specify on request the use of Crestron interface with led

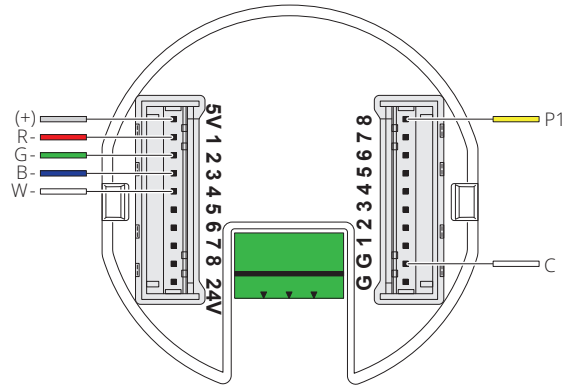

CONNECTION WITH LUTRON QSE-CI-WCI

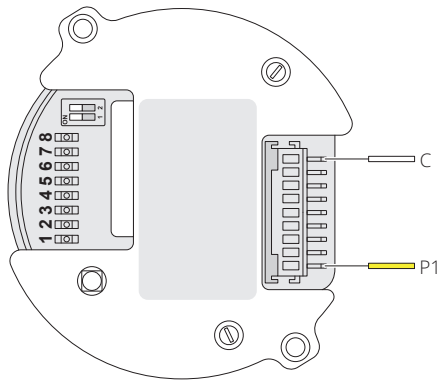

CONNECTION WITH LUNATONE MC+(DALI)

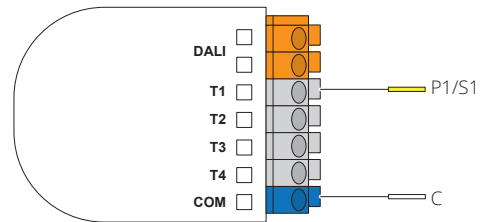

CONNECTION WITH THEBEN TA 8 S KNX(KNX)

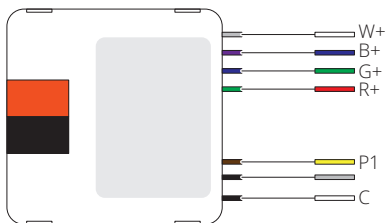

CONNECTION WITH SHELLY i4 DC

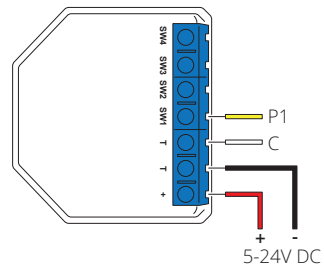

CONNECTION WITH BTICINO MYHOME BTI-3477

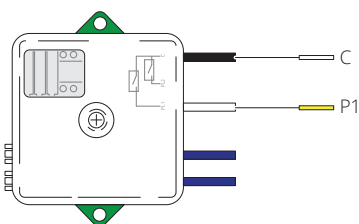

CONNECTION WITH LOXONE Nano DI Tree 100242

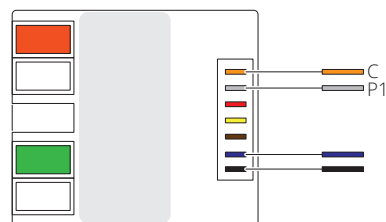

Montaggio - Assembly - Montage - Montage - Монтаж - 装配

1 OLD TYPE

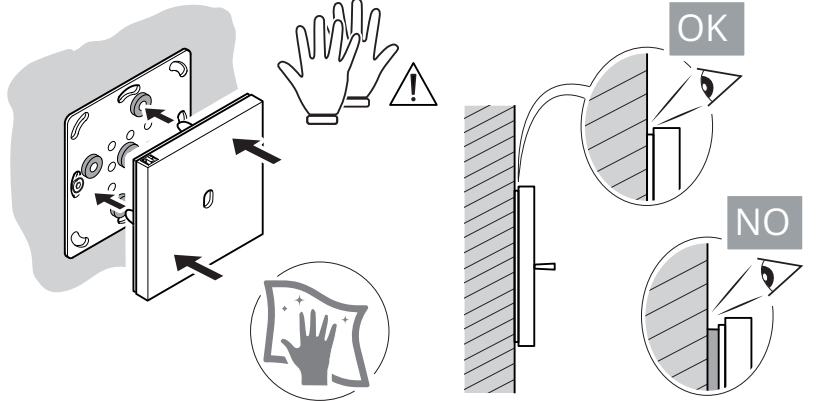
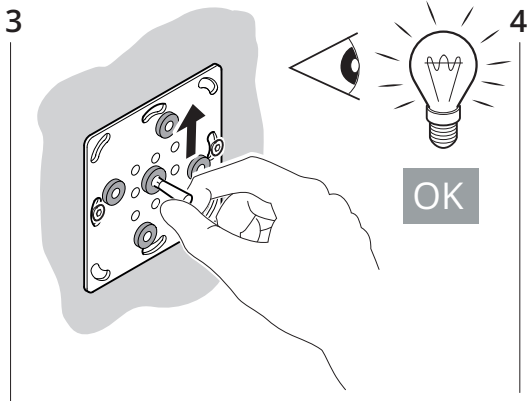
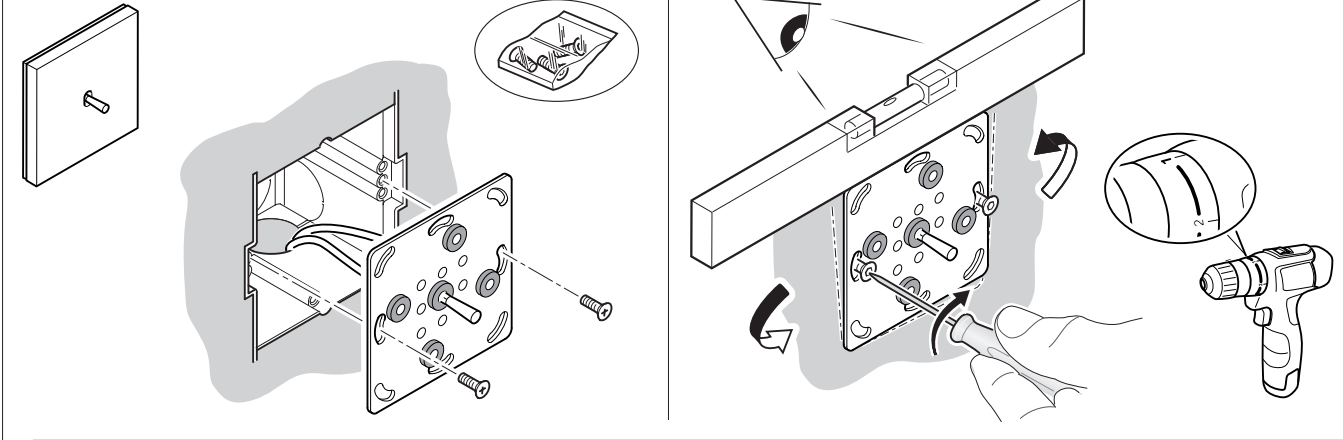

1 NEW TYPE

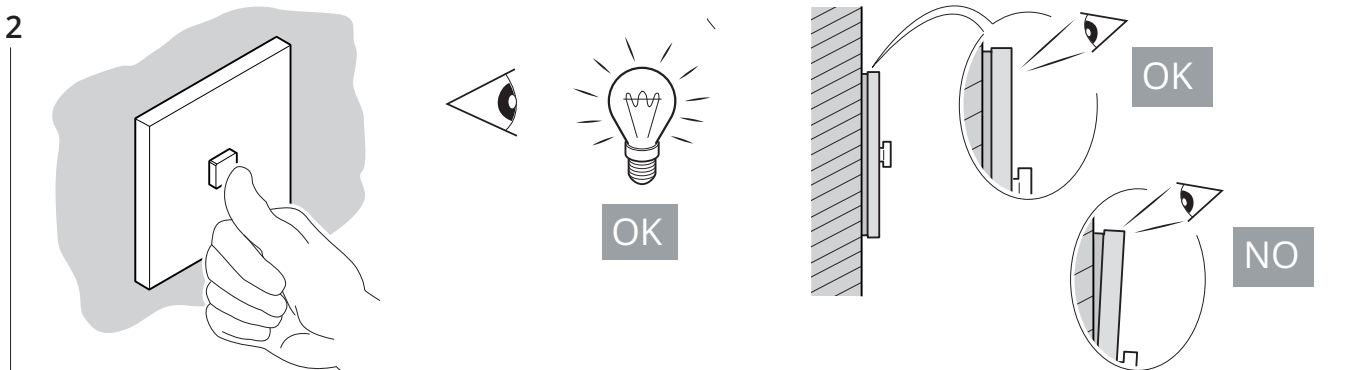
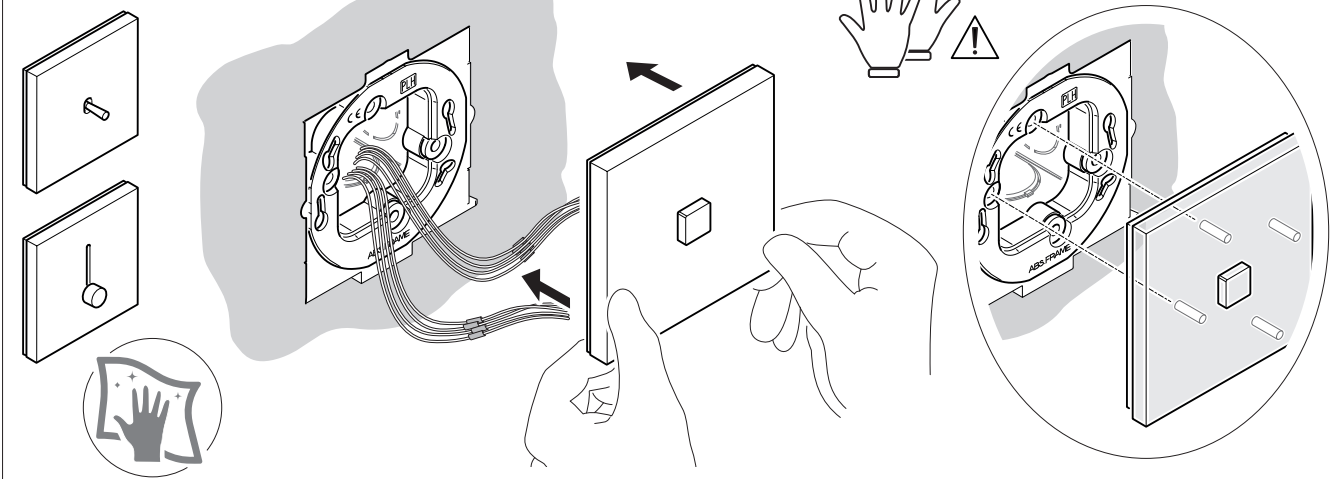

Pulizia e manutenzione - *Cleaning and maintenance* - Nettoyage et entretien - *Reinigung und Wartung*  
 - Limpieza y mantenimiento - *Очистка и техническое обслуживание* - 清洁及维护

Non utilizzare spray, solventi, abrasivi o prodotti chimici. / Do not use any spray, solvents, abrasives or chemicals.  
 N'utilisez pas de sprays, de solvants, d'abrasifs ou de produits chimiques. / Keine Sprays, Lösungsmittel, Scheuermittel oder chemische Erzeugnisse verwenden.  
 Non utilizzare spray, solventi, abrasivi o prodotti chimici. / Не используйте спреи, растворители, абразивные средства или химикаты.  
 不要使用喷雾、溶剂、磨料或化学产品。



Panno Asciutto / Dry Cloth  
 Chiffon sec / Trockenes Tuch  
 Paño Seco / Сухая ветошь  
 干布

Utilizzare su finiture trattate, salvo diverse  
 specifiche indicazioni.

*Use on treated finishes, unless different  
 specific indications.*

À utiliser sur les finitions traitées, sauf  
 indications contraires.

Auf behandelten Oberflächen verwenden, außer  
 anders lautenden Angaben.

Utilice sobre acabados tratados, con la excepción de diferentes  
 indicaciones específicas.

*Используйте для обработанных поверхностей, если  
 не указано иное.*

除非另有说明，  
 否则用于处理过的饰面。



Panno in Microfibra / Microfibre Cloth  
 Chiffon en microfibre / Mikrofaserstuch  
 Paño de Microfibras  
 Микроволоконная салфетка  
 微纤维布

Utilizzare su trattamenti galvanici  
 es. cromature, oro...

*Use on galvanic treatments  
 es. chrome, gold...*

Utilisation sur les traitements galvaniques  
 par exemple, le chromage, l'or...

Auf galvanischen Behandlungen,  
 z.B. Verchromung, Vergoldung... verwenden.

Utilice sobre tratamientos galvanicos  
 como cromados, oro...

*Используйте для гальванических поверхностей, например  
 для хромированных, позолоченных и других отделок.*

用于电镀处理  
 如镀铬、金...

Smaltimento imballaggio - *Disposal of the packaging* - Élimination des emballages - *Entsorgung der  
 Verpackung* - Eliminación del embalaje - *Утилизация упаковки* - 包装的处置

L'imballo deve essere smaltito secondo le specifiche normative locali vigenti.  
 Materiale esterno: Cartone e nastro adesivo.  
 Materiale Interno: Polietilene Reticolato.

*The packaging must be disposed of according to the specific local regulations  
 in force.*

*External material: Cardboard and adhesive tape.*

*Internal material: Cross-linked Polyethylene.*

L'emballage doit être éliminé conformément aux réglementations locales  
 spécifiques en vigueur.

Matériau extérieur : Carton et ruban adhésif.

Matériau interne : Polyéthylène réticulé.

Die Verpackung ist entsprechend der spezifischen örtlichen geltenden  
 Vorschriften zu entsorgen.

Äußeres Material: Karton und Klebeband.

Inneres Material: Vernetztes Polyethylen

*El embalaje se debe eliminar según las normativas específicas locales vigentes.*

*Material externo: Cartón y cinta adhesiva.*

*Material Interno: Polietileno Reticulado.*

Упаковка утилизируется в соответствии со специальным действующим  
 местным законодательством.

Наружный материал: Картон и клейкая лента.

Внутренний материал: Сшитый полиэтилен.

*应根据当地现行法规处置包装。*

*外部材料：纸箱和胶带。*

*内部材料：交联聚乙烯。*







Devices with soul.

---

Seguire sempre le norme di sicurezza  
protegge te e chi ti sta vicino.

*Always follow the safety rules  
protects you and those around you.*

Suivre toujours les règles de sécurité  
protège vous-même et ceux qui vous entourent.

Stets die Sicherheitsvorschriften befolgen,  
schützt Sie selbst und die umstehenden Personen.

Siempre siga las normas de seguridad,  
protege a usted y a quienes le rodean.

*Соблюдение правил техники безопасности  
защищает вас и окружающих людей.*

务必遵守安全规定  
保护自己和身边的他人。

[www.plhitalia.com](http://www.plhitalia.com)



@plhitalia

#plhitalia  
#shakeyourlight